

KIMANA is the new hinge conceived by Italiana Ferramenta to open and close flap and drop-down doors. Provided with a unique and exclusive movement, it allows to open cabinet doors in column, even when the cabinet bottom lies upon another panel or the cabinet top is surmounted by a decorative/lighting panel.

The small dimensions (\varnothing 26mm boring for both the door and the bottom), the minimalistic and elegant design contribute to make **KIMANA** not only a functional hinge, but also a product unique in its genre. The fixing screws are perpendicular, thus making **KIMANA** suitable for perfect positioning, as well as for aluminium profiles. **KIMANA** can be easily adjusted through the screws (PZ2) which are hidden underneath the cover.

Various door and cabinet thickness-combinations can be solutioned either by carrying out the adjustments of the Kimana or by plaining adapters under the hinge clip so that the ideal movement and alignment of the door are guaranteed.

PAT. PENDING
REGISTERED DESIGN



DRILLING PLAN

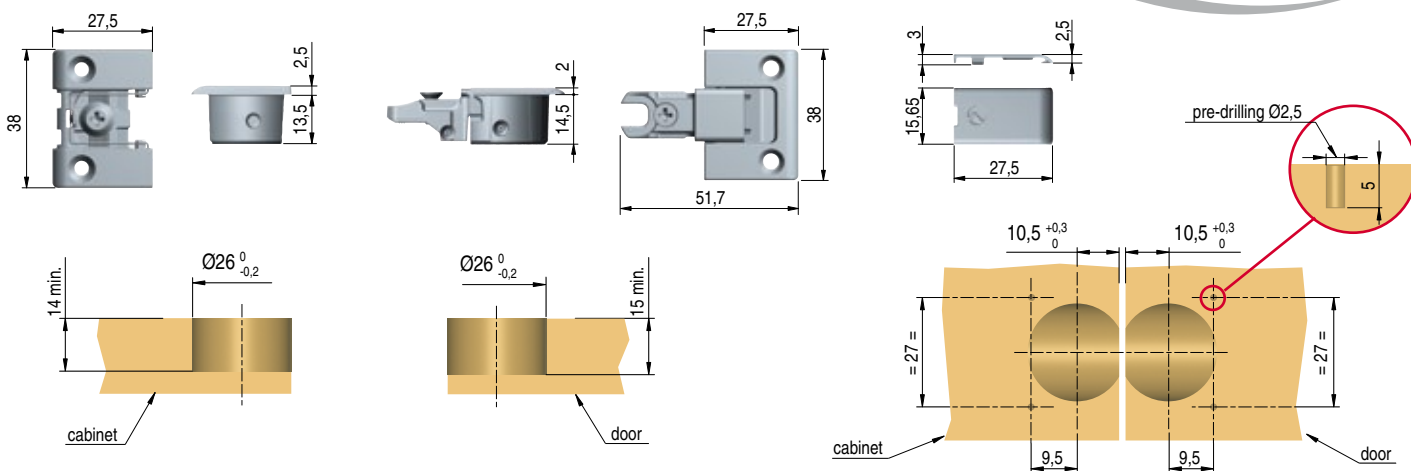

Part. no	Description	Finish
40115000YA	Plate for Kimana	Nickel-plated
60101390YA	screw \varnothing 3,5x16	Nickel-plated

Part. no	Description	Finish
40115010YA	Kimana hinge	Nickel-plated
60101390YA	screw \varnothing 3,5x16	Nickel-plated

Part. no	Description	Finish
40115040YA	Cover cap	Nickel-plated

INSTALLATION ON THE CABINET (MINIMUM THICKNESS 18 MM)

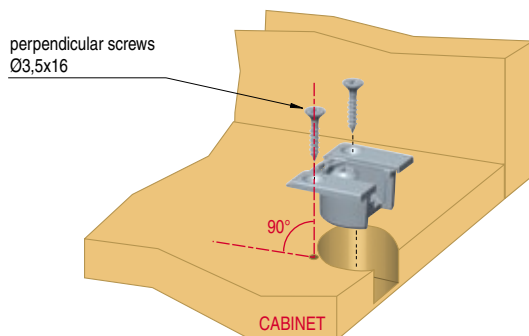

INSTALLATION ON DOOR (MINIMUM THICKNESS 18 MM)

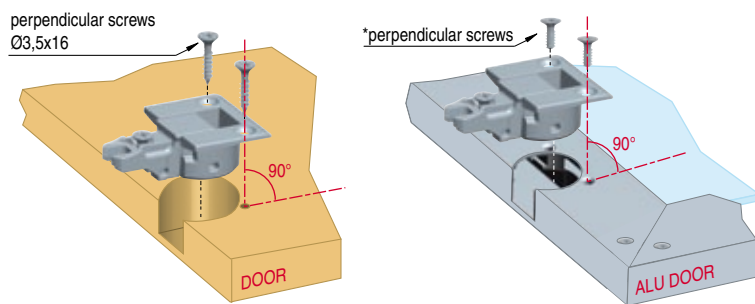

*to be selected according to alu profile section.

DOOR INSTALLATION



LATERAL ADJUSTMENT 0 ± 1 mm

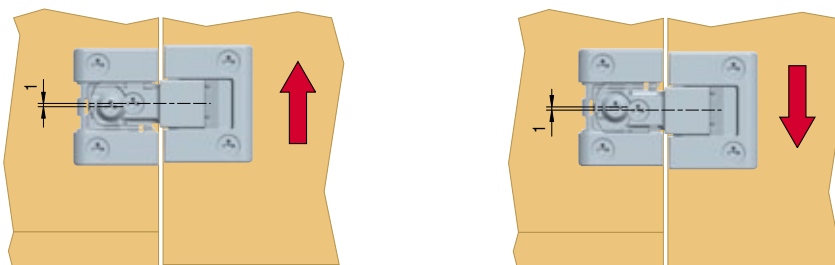

IN-DEPTH ADJUSTMENT 0+2mm

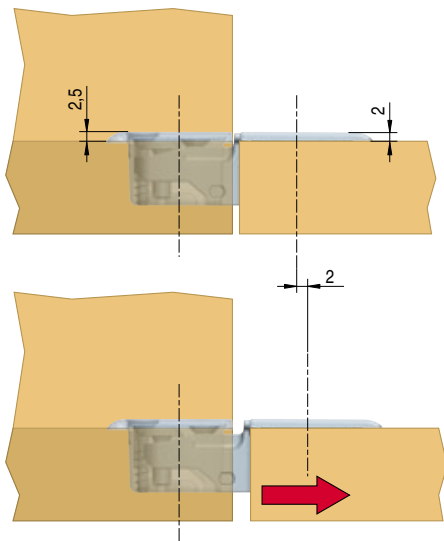

LOCKING

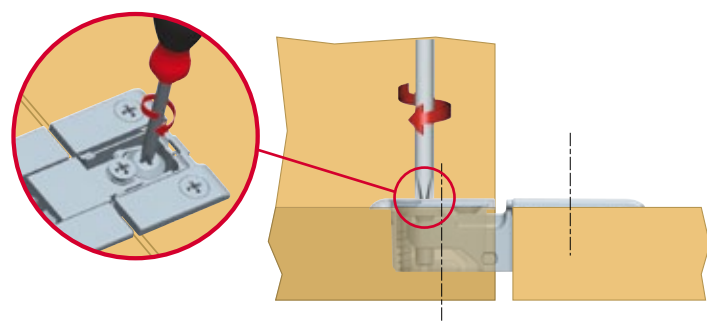

CUSTOMIZED KIMANA COVER CAP

It is possible, upon request, to customize Kimana cover cap with **your company logo** (min. qty 5000 pcs).

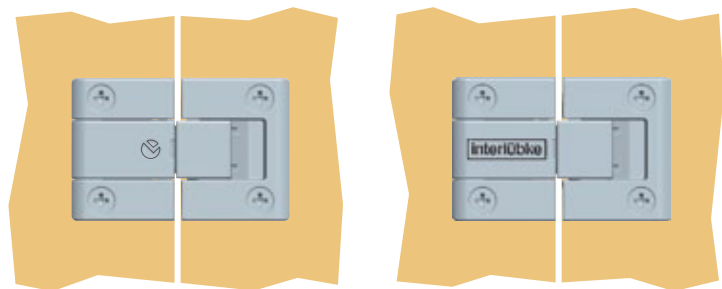

CASES WHERE TO USE KIMANA

CABINET PLACED ON A PLATFORM

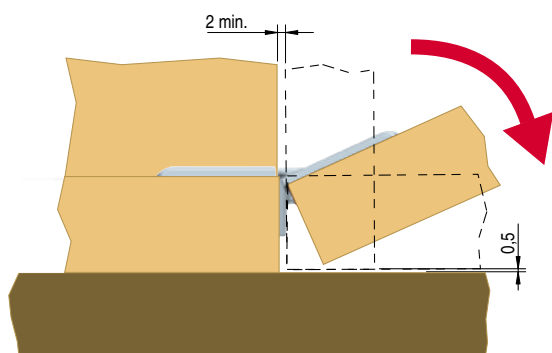

A 0,5 mm gap between the door and the platform laying underneath doesn't interfere with the opening.

VERTICAL ADJUSTMENT 0+2mm

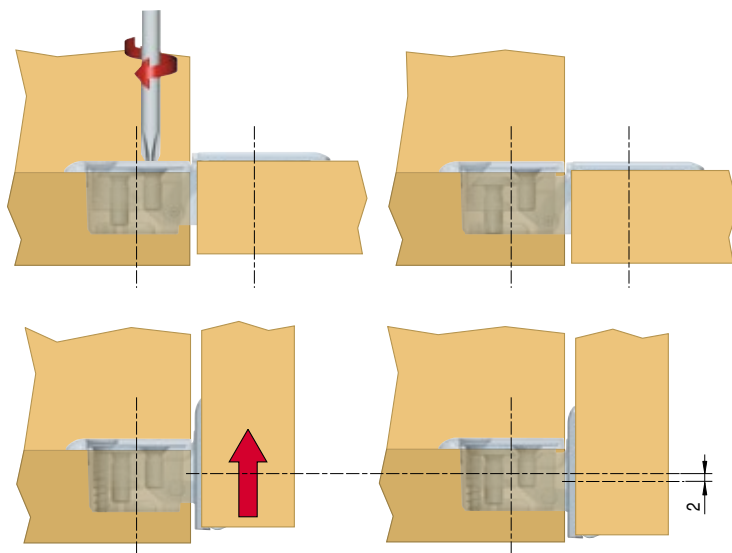

COVER CAP INSERTING

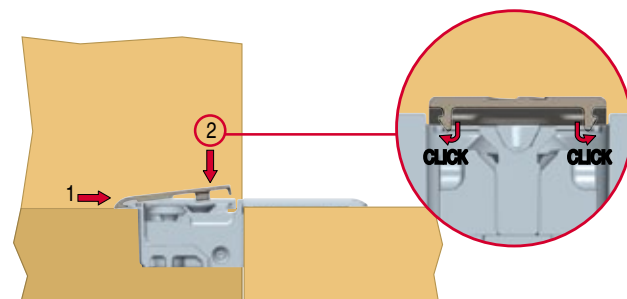

COVER CAP UNINSERTING

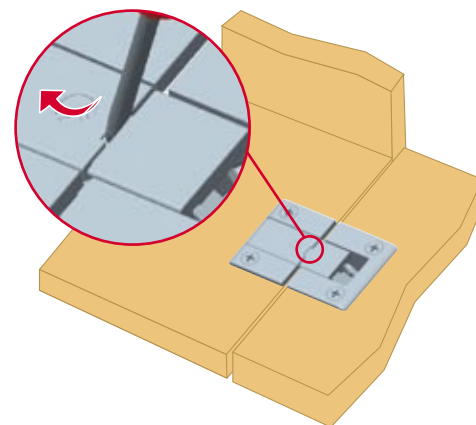

CABINET IN COLUMN

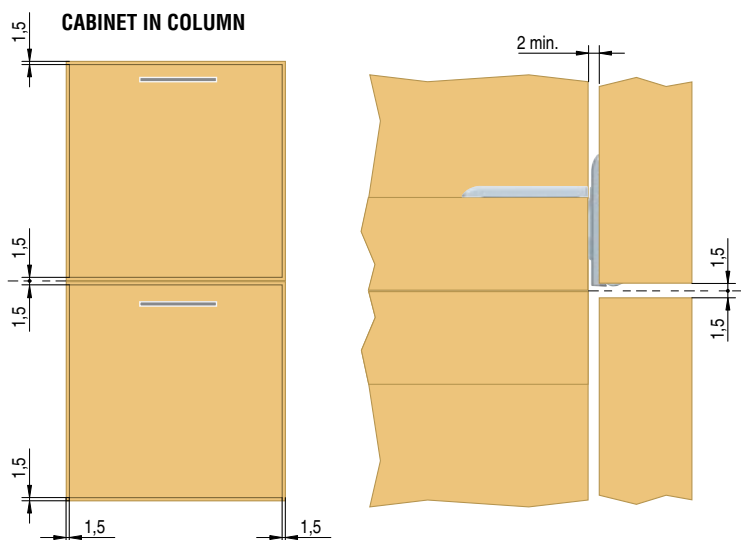

CABINET 19mm THICK WITH DIFFERENT DOOR THICKNESSES

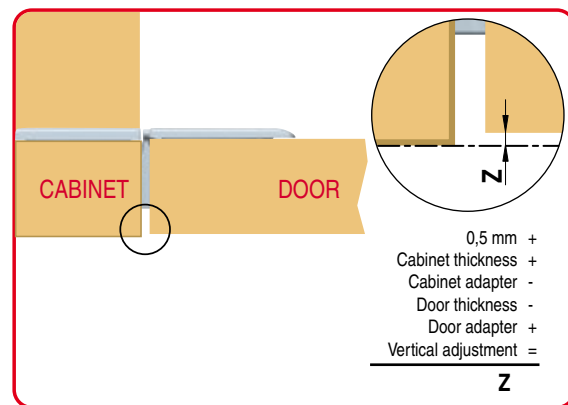
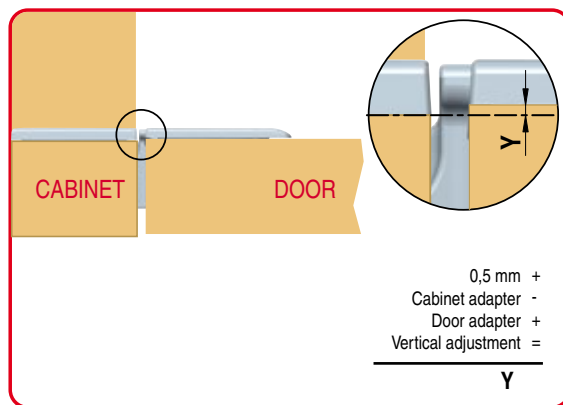
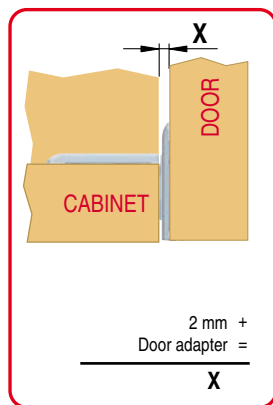

CABINET 19mm WITHOUT ADAPTER - DOOR 20mm WITHOUT ADAPTER

0 + 2mm FURTHER VERTICAL ADJUSTMENT

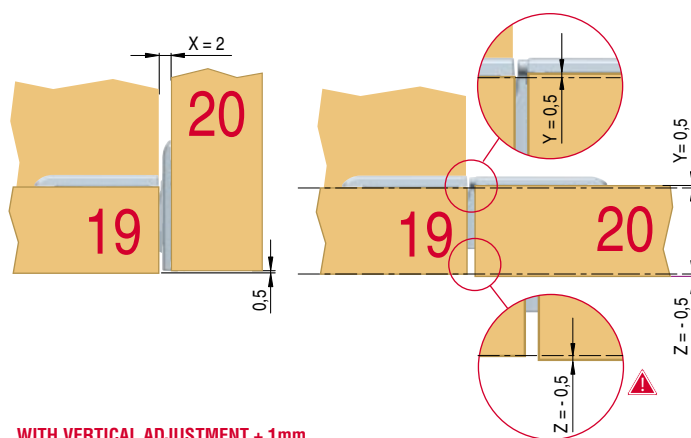
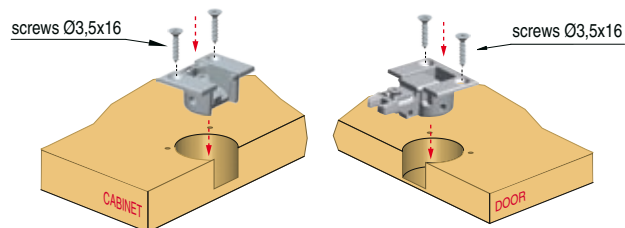

WITH VERTICAL ADJUSTMENT + 1mm

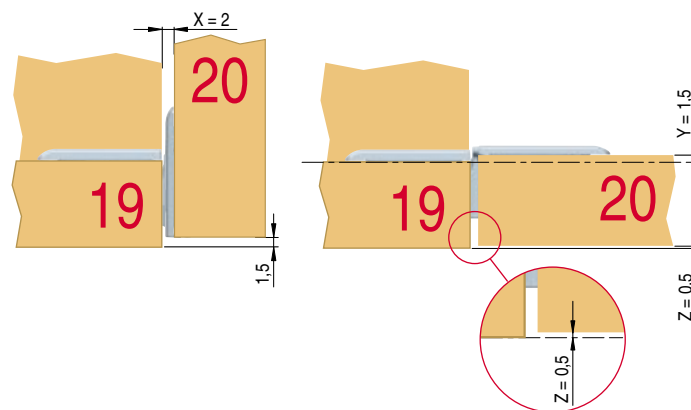

CABINET 20mm THICK

CABINET 20mm WITHOUT ADAPTER - DOOR 20mm WITHOUT ADAPTER

0 + 2mm FURTHER VERTICAL ADJUSTMENT

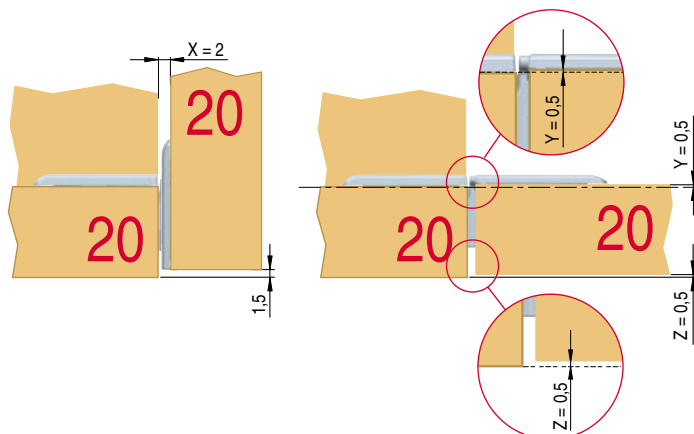
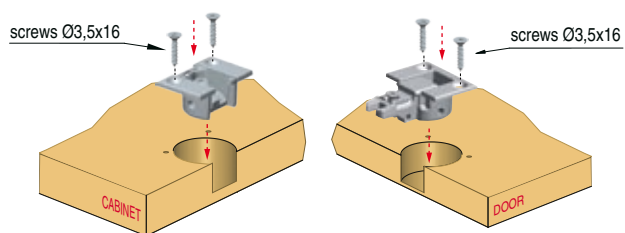

DRILLING PLAN SUGGESTIONS TO MODIFY "X" AND "Z" WHEN THE DOOR IS CLOSED

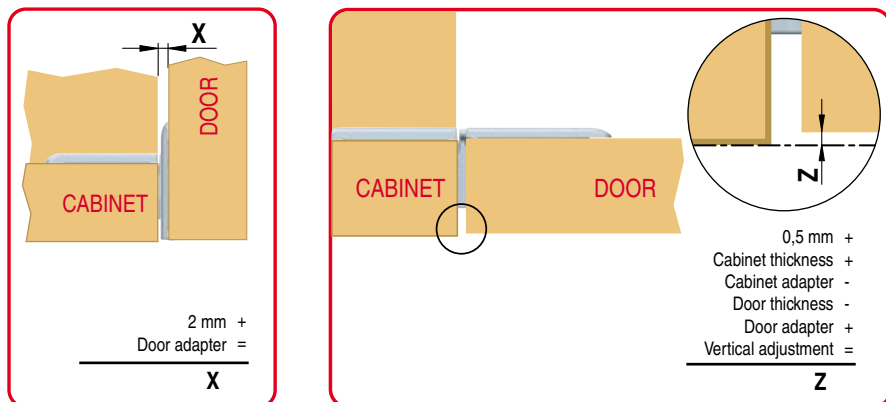

STANDARD DRILLING PLAN

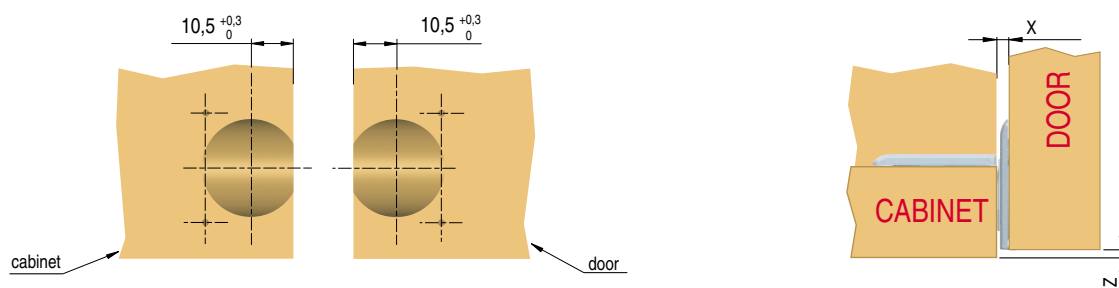

ALTERNATIVE DRILLING PLANS

