

Häfele Tavoflex



- > The table top is lifted easily using gas-filled struts.
- > The integrated soft closing mechanism provides gentle, silent closing.
- > With safety catch to prevent unintentional closing.



- > Area of application: For raising and forward swivelling of table tops and worktops, e.g. for coffee tables
- > Version: Side covers prevent fingers being trapped
- > Material: Steel
- > Finish: White aluminium, similar to RAL 9006
- > Load bearing capacity: Approx. 5 kg
- > Installation width: ≤698 mm
- > Installation: For screw fixing into pre-drilled 32 mm series drilled holes
- > Recommended panel thickness 16 mm



4

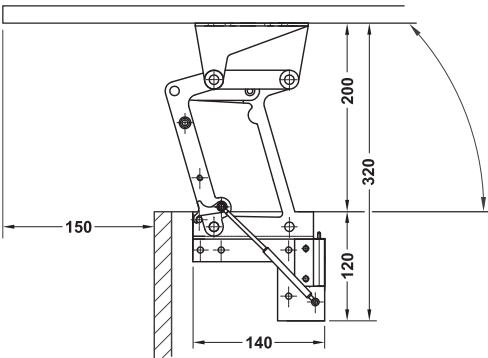

Drilling pattern

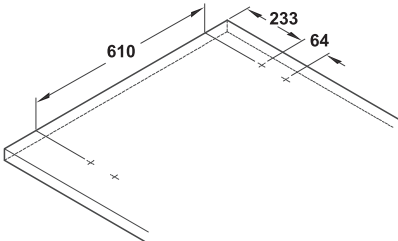
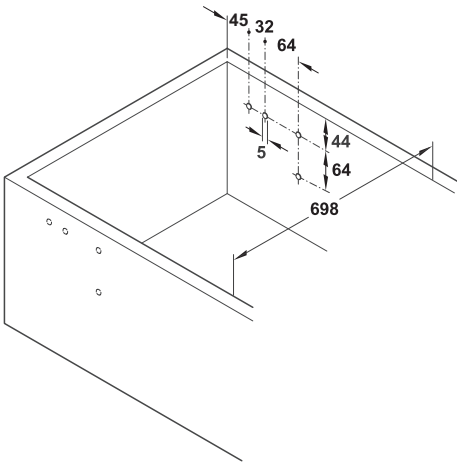

Table top



Cabinet

Note

Minimum gap to fixed table top 6 mm

Supplied with

- 1 pair of swing-up table top fittings
- 1 cross bar
- 1 set of installation instructions

Finish	Cat. No.
White aluminium, similar to RAL 9006	643.12.201

Packing: 1 or 5 sets

Swing-Up Table Top Fitting